

Art Competition Memorial to General Kutlvašr in Nusle Brewery

RULES OF THE
COMPETITION
AND
COMPETITION
BRIEF

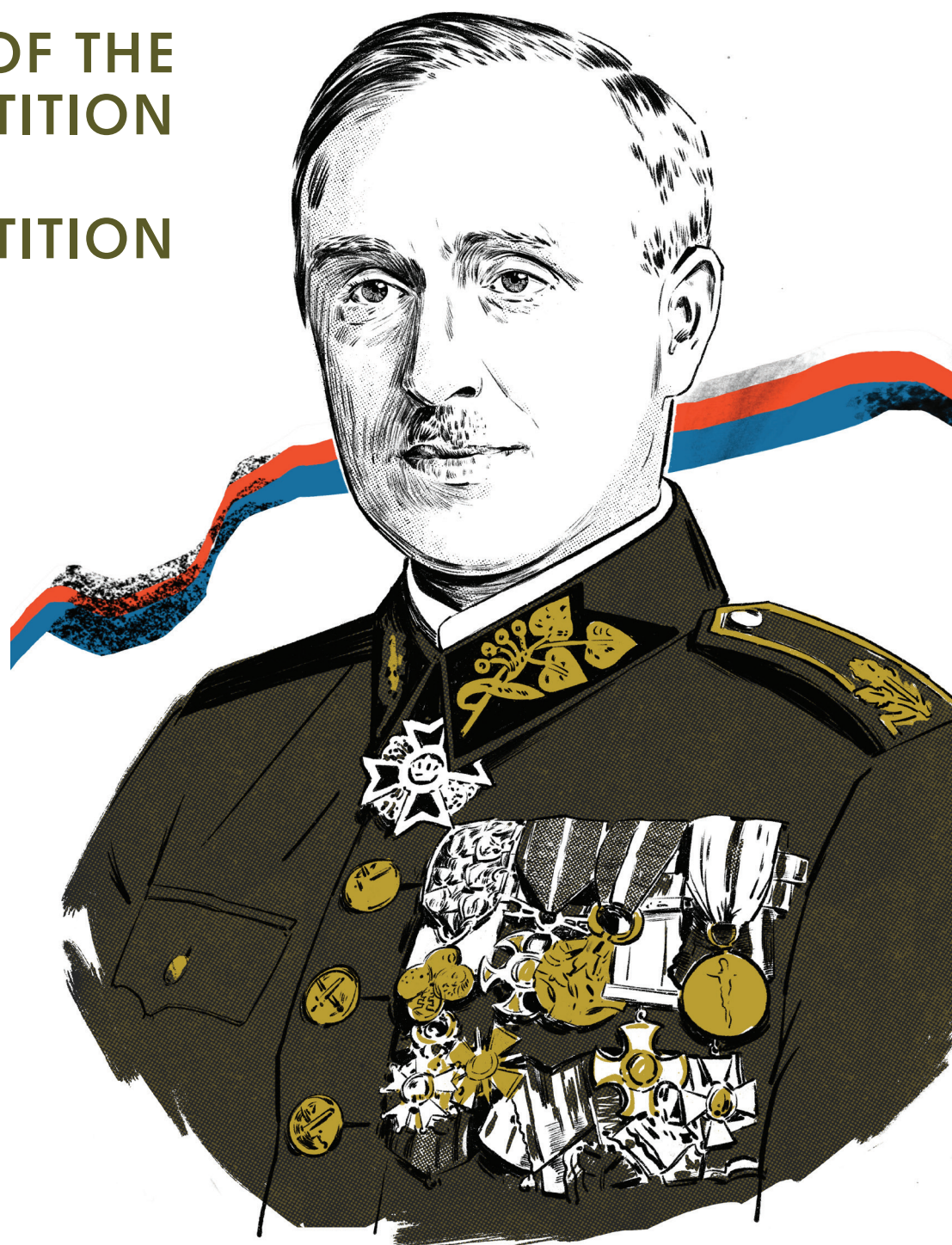

Art Competition

Memorial to General Kutlvašr

in Nusle Brewery

**RULES OF THE
COMPETITION
AND
COMPETITION
BRIEF**

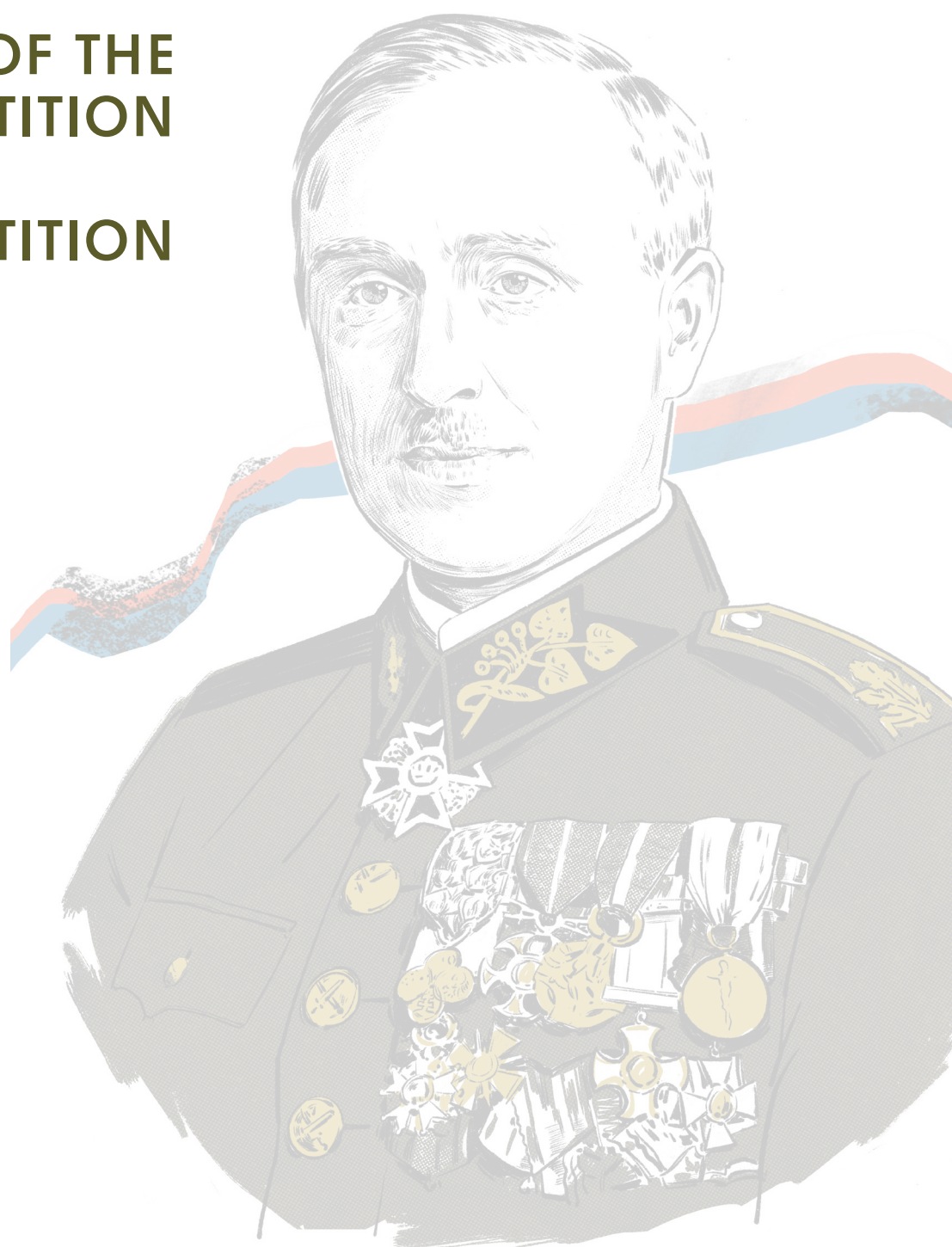

The Rules of the Competition and the Competition Brief were approved by the competition jury at the initial jury meeting on 24 January 2024.

The Rules of the Competition were approved by the competition client on 25 January 2023.

Table of Content

1	Key Information about the Competition	7
1.1	Aim of the Competition	8
1.2	Type of the Competition	8
1.3	Competition Timetable	8
1.4	Follow-On Contract	8
1.5	Competition Client, Organiser and Competition Jury	9
1.6	Competition Participants	10
2	Competition Brief	11
2.1	Scope of the Competition	12
2.2	Theme of the Memorial	12
2.3	Location and requirements for technical design of the work	13
3	Course of the Competition	15
3.1	Competition Phase 1	16
3.2	Competition Phase 2	19
3.3	General Terms	20
4	Additional Information	23
4.1	Kdo byl generál Karel Kutlvašr?	25
4.2	Nusle Brewery Regeneration Project	29

1 Key Information about the Competition

1.1 Aim of the Competition

The aim of the competition is to find the most suitable proposal for the memorial to General Karel Kutlvař, which will be placed in the public space of the newly developing Nusle Brewery residential area.

1.2 Type of the Competition

The competition will have two phases. In Phase 1, the competition is open, anonymous. For the Phase 2, the jury will shortlist maximum of 7 competition participants who will proceed to Phase 2. In the Phase 2, the competition will be non-anonymous.

1.3 Competition Timetable

The tentative competition timetable is shown in **Table 1**. The dates in Competition Phase 2 may change depending on the competition proceedings; nevertheless, the minimum time set for the development of the competition proposal will be followed.

The information on the competition dates will be published on the competition website www.onplanlab.com/souteze/umelecka-soutez_pomnik-general-a-kutlvasra-v-nuselskem-pivovaru/.

1.4 Follow-On Contract

Given the nature of the work as an art installation, the competition client expects to negotiate with the competition winner to conclude contract for the preparation of complete proposal and production documentation, and for the creation and delivery of the work.

The competition client expects the costs for the implementation of the artwork, including the fee for the preparation of the necessary documentation for the implementation of the work, to amount to CZK 1,500,000 excluding VAT.

The costs of the construction preparation and implementation of any technical infrastructure will be covered by the competition client (they will not be included in the estimated cost of implementation of the work).

The artwork is expected to be implemented by the opening of the passage of the Nusle Brewery's historical building, i.e. in March 2025.

Table 1 Tentative competition timetable

Competition Phase 1	Competition announcement	5 February 2024
	Site visit	22 February 2024
	Submission of proposal concepts for the memorial to General Karel Kutlvař	until 18 April 2024, 17:00 CEST
	Evaluation jury meeting and selection of maximum of 7 concepts whose authors will proceed to the Competition Phase 2	within 14 days after the deadline for the memorial concept submission tentatively 22–25 April 2024
Competition Phase 2	Submission of proposals for the memorial to General Karel Kutlvař	no later than 50 days after delivery of the invitation to participate in Competition Phase 2 tentatively until 20. June 2024, 17:00 CEST
	Competition workshop where the authors will present their proposals and the jury will select the competition winner	within 14 days from the submission of proposals tentatively 24–27 June 2024
Exhibition	Exhibition of the competition proposals	within 3 months from the competition end

1.5 Competition Client, Organiser and Competition Jury

Rezidence Nusle s.r.o. of Penta Real Estate company is the competition client.

The selection of the most suitable proposal will be decided by an expert jury consisting of independent renowned experts, representatives of the competition client and the Prague 4 Municipality.

1.5.1 Competition Client

Rezidence Nusle s.r.o.
Na Florenci 2139/2
110 00 Prague 1

1.5.2 Competition Organiser

ONplan lab, s.r.o.
Karmelitská 18/379, 118 00 Prague 1

Competition Secretary: Karolína Koupalová
Competition Proposal Examiner: Dorotea Dlesková

1.5.3 1.5.3 Competition Jury

Independent members

Regular members	
Marie Foltýnová	curator, Prague City Gallery
Tomáš Džadoň	sculptor
Osamu Okamura	architect and pedagogue
Ondřej Horák	curator
Substitute members	
Jiří Ptáček	art historian and curator
Linda Obršálová	architect

Dependent members

Regular members	
Michal Hroza	City of Prague
David Musil	Penta Real Estate
Martina Chisholm	architect, CMC Architects
Substitute members	
Petr T. Opletal	Prague 4 Municipality
Petr Palička	Penta Real Estate
Rudolf Vacek	Penta Real Estate
Jan Tesárek	architect, CMC Architects

1.5.4 Invited Experts

Invited experts will assist the jury by reviewing the competition proposals and providing an expert opinion:

- **Martin Špičák**, IPR Prague
- **Pavel Švec**, member of the General Karel Kutlvašr family
- **Eduard Stehlík**, military historian, director of Lidice Memorial

The jury can ask the competition clients to invite other experts over the course of the competition.

1.6 Competition Participants

Anyone who meets the conditions for participation in the competition and submits proposal concept for the memorial to General Kutlvašr in the Competition Phase 1 by the deadline (see chapter 3.1.4) will become competition participant.

1.6.1 Conditions of Participation in the Competition

The competition is open to individuals and corporate bodies, or their companies, who meet the requirements of these Rules of the Competition and who:

- a. have created at least one artwork public space, and further:
- b. have not been involved in the preparation of the Competition Brief and competition announcement, with the exception of persons who prepared mapping or analytical documents,
- c. are not regular or substitute members of the competition jury, competition secretary, examiner of the competition proposals, invited expert or husband/wife, direct relative, permanent project partner or their immediate superior or co-worker,
- d. are not members of the statutory bodies or employees of the Competition Clients or legal entities established by the clients, they are not employees of organizations that participated in discussing and approving the Competition Brief and Rules of the Competition nor of authorities participating in deliberations of the results arising from the competition.

1.6.2 Proof of Compliance with the Conditions for Participation in the Competition

a/ Portfolio of reference works

The participant shall demonstrate compliance with the conditions set out in section a) of paragraph 1.6.1 by submitting portfolio of reference works that includes at least 3 works, at least one of which is work of artwork in public space. The author of the works included in the portfolio must be the author or co-author of the competition proposal. The portfolio of reference works will be submitted in separate document in pdf format.

The portfolio of reference works will be reviewed by the competition secretary for compliance with the requirement in section a) of paragraph 1.6.1. The portfolio will not be submitted to the jury – this will not breach the anonymity of the competition proposal.

b/ Sworn Statement – form P05

The participant shall demonstrate compliance with the conditions set out in sections b) to d) of paragraph 1.6.1 by Sworn Statement – by completing and signing form P05. If more than one individual or corporate body submits competition proposal jointly, the Sworn Statements must be submitted by each of these persons.

The sworn statement will not be submitted to the jury – this will not breach the anonymity of the competition proposal.

2 Competition Brief

2.1 Scope of the Competition

memorial to General Karel Kutlvař, Czechoslovak legionnaire who led the Prague Uprising in May 1945, is to be erected in the new district on the site of the former Nusle Brewery. After February 1948 Karel Kutlvař became victim of the communist regime and was imprisoned until the amnesty in 1960. At the end of his life he worked as security guard and night gatekeeper at the Nusle brewery.

Placing the artwork in the public space of the new district aims to culture and enliven the main public space of the area, to stimulate the attention of its users and above all to recall the legacy of Karel Kutlvař. Although General Karel Kutlvař is an important personality in our history, he is currently commemorated only by bust at the Prague 4 Town Hall and the square near the brewery bearing his name.

2.2 Theme of the Memorial

The aim of the memorial to General Karel Kutlvař is to commemorate his legacy in dignified manner, especially such virtues as heroism and humanity that characterise his life. The work should communicate the story of Karel Kutlvař in contemporary language to present and future generations and should embrace the following values and qualities:

The work shall educate, communicate and open up discussion

One of the important functions of the memorial is to be reminder of history and open up discussion on the importance of contemporary issues communicated by the memorial to the general public. The artwork should not only educate the present young generation but also open targeted intergenerational dialogue. Its form and content should express and communicate the personality of Karel Kutlvař and the importance of his story. At the same time, it should remind in an understated way of the often incomprehensible and complicated history of the 20th century, which is mirrored in the life story of Karel Kutlvař and stimulate the viewer's interest in learning more. The work should arouse emotions, it should not leave the viewer indifferent.

The work shall be timeless and speak to all generations

The form and content of the artwork should be able to communicate not only with the present generation, but also with those of the future. The visual language of the work should reflect the time of its creation however, it should speak to those who will come after us.

The work shall reflect on the contemporary perception of patriotism and heroism

The artwork should provide an opportunity to identify how the concept of *patriotism* and *heroism* is perceived by the contemporary generation and try to define this notion. The work should communicate ideas such as service to one's country, love of one's country, and the theme of personal sacrifice for the sake of higher moral values. Karel Kutlvař remained steadfast in his attitudes and values despite the dramatic social and political changes in the 20th century. The work can also contribute to repair injustice which not only affected Karel Kutlvař, but also other heroes in the past.

The work shall tell story

The artwork should fully reflect the meaning of the word memorial. It has root in the word "memory", i.e. to remember, to recall. The memorial should represent link between the past, the present and the future. It shall project history to the present time and in this way communicate an important message which must be remembered. Our memory remembers best when information is put in context and transformed into story. The work should tell the life story of Karel Kutlvař. It should reflect the fragility, diversity, and complexity of the life journey of man of strong character who lived in different political regimes and each of them treated him differently, although he always maintained his inner integrity.

The work shall co-create the identity of the site and shall stimulate activities and events in the public space

The work should be part of the square and its form and location should help to create living public space that invites people to stay there and use the space. The work can include series of activities, performances, lectures and other supporting programmes that will underline the overall impact of the memorial and will encourage more people to reflect on the meaning of this work and its message.

Assignment:

Design work that will commemorate the legacy of General Karel Kutlvař in respectful manner, will communicate his story in contemporary language, and will have the values and qualities listed above.

2.3 Location and requirements for technical design of the work

The artwork will be located in the central public space of the newly developing district, which is defined by the revitalised historic brewery building to the south and the new residential development to the north. The extent of the area where competition participants may place the memorial (the site) is defined in **Scheme 1**.

The site is located at the crossroads of the future main pedestrian routes leading through the brewery area. In the east-west direction, the main street passes through the site, which is connected to the south by ramp to commercial passage that leads through the historic brewery building towards new footbridge over the Botič stream and further to the tram stop Divadlo Na Fidlovačce in Křesomyslova Street. In the southern part, the front garden of the café, shaded by trees, is

also adjacent to the site. To the north, the site is adjacent to new residential buildings with public amenities in the ground floor (**Scheme 2**). Smaller farmers' markets and social and cultural events of more intimate nature are expected to take place in the site. The artwork will thus be an integral part of vibrant public space.

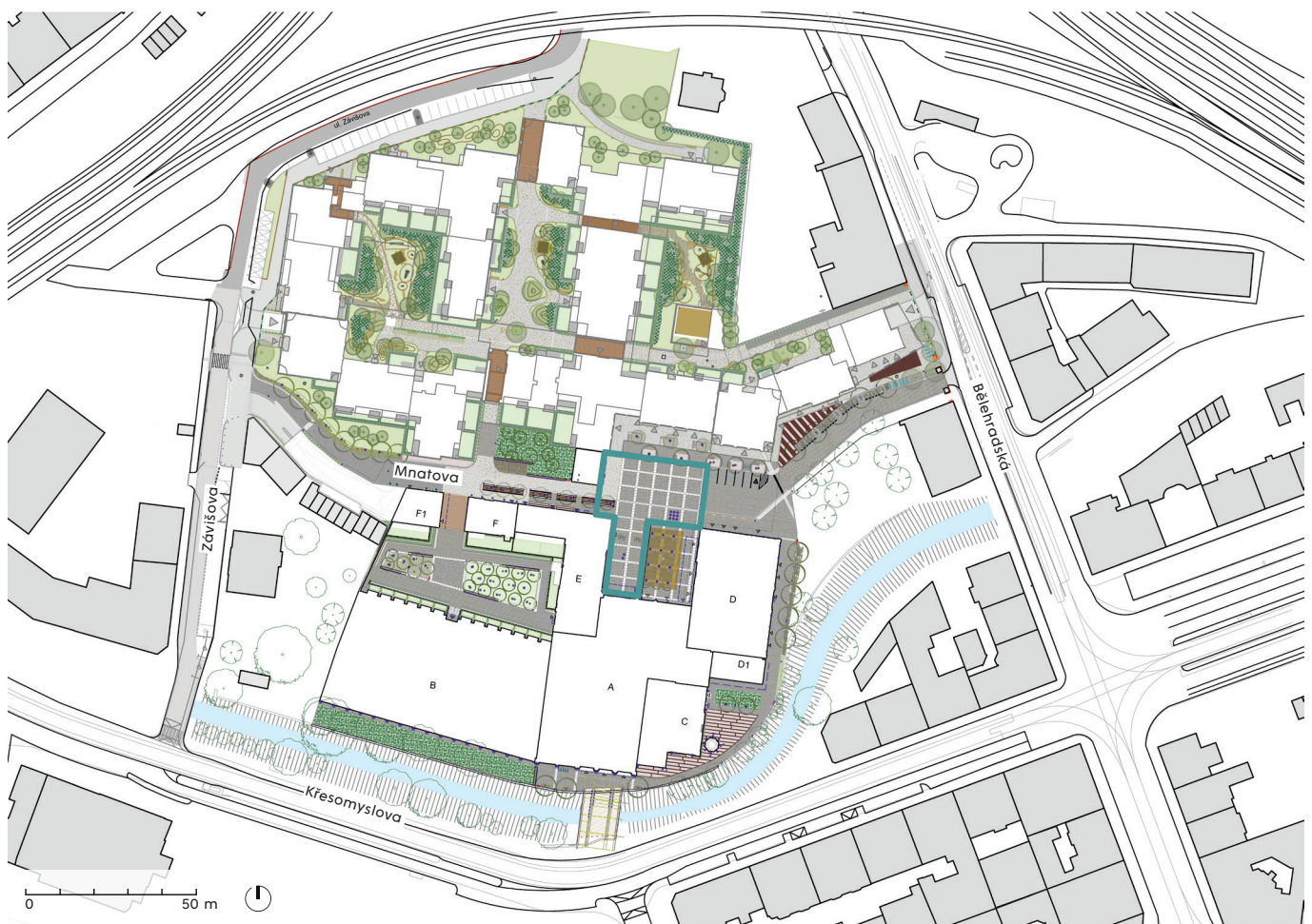





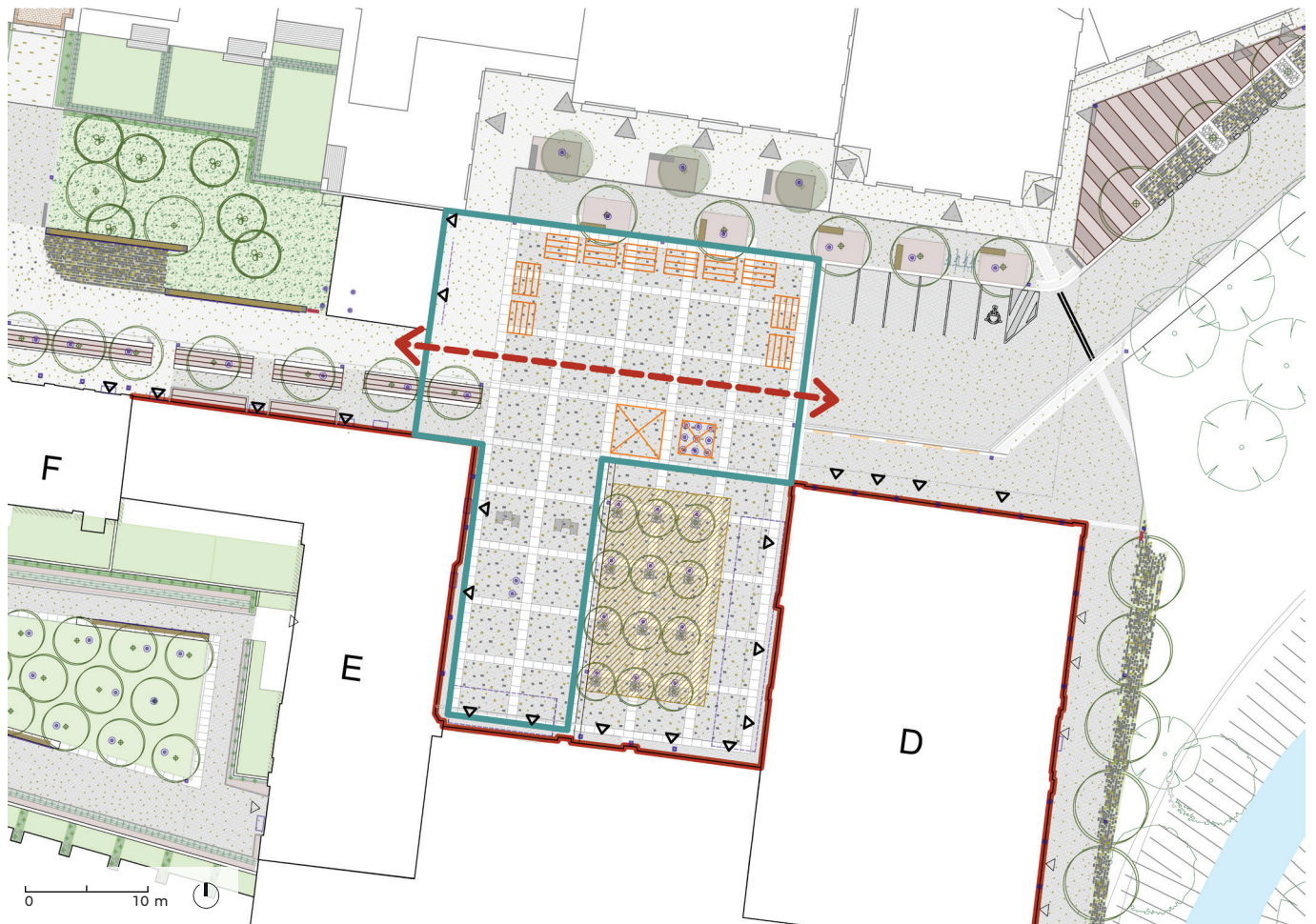

Scheme 1 Delimitation of the site in the wider context of the Nusle Brewery area, source: Penta Real Estate, 2023, modified by: ONplan, 2023

 the site



Scheme 2 Limits of the memorial to General Karel Kutlvař location in the site, source: Penta Real Estate, 2023, modified by: ONplan, 2023

	the site
	entrances to the buildings
Limits of the site:	
	facades of listed buildings
	passage for the traffic service and emergency medical services
Expected use of the space:	
	preparation for the stage
	water feature
	considered stands for occasional markets

Assignment:

- *Design work customised to the site. Respect and relate to the urban and architectural design of the Nusle Brewery. The work may blend into the adjacent public space, but must not decrease its functional values and become barrier in the area. The work may also be integrated into the facades of adjacent buildings, but must not reduce the living comfort of the area and must respect the values of listed buildings.*
- *Design permanent work. Use technical solutions and materials that will withstand weather conditions in the long term and will not require excessive maintenance.*
- *In the site, place the memorial to General Karel Kutlvař taking into account its limits, as shown in Scheme 2.*

3 Course of the Competition

3.1 Competition Phase 1

The competition proposal in Competition Phase 1 must be submitted by 17:00 on 18 April 2024. The proposal must comply with the binding requirements for content set out in chapter 3.1.5.

At the end of Competition Phase 1, the jury will select maximum of 7 concept artworks, whose authors will be invited to participate in Competition Phase 2.

3.1.1 Materials Provided

The Rules of the Competition and Competition Brief are freely available in *pdf format on the competition website www.onplanlab.com/souteze/umelecka-soutez_pomnik-general-a-kutlvasra-v-nuselskem-pivovaru/.

The Nusle Brewery project is presented on the website www.nuselky-pivovar.com.

For entrants interested in participating in the competition, the following documents will be provided after registration into the Karel information system (IS) on the competition website www.onplanlab.com/souteze/umelecka-soutez_pomnik-general-a-kutlvasra-v-nuselskem-pivovaru/:

- P01 Project of the site in *pdf and *dwg formats
- P02 Visualisation of the surroundings of the site and elevations
- P03 Additional literature
- P04 Photos of Karel Kutlvař
- P05 Identification form and Sworn statements

Entrants are obliged to use the documents only for the purpose of deciding whether to participate in the competition and for the preparation of the competition proposal.

3.1.2 Competition Phase 1 Questions

Entrants may only submit questions in writing to the following email address: dotazy@kutlvasr.onplanlab.com.

Entrants may raise questions related to the Rules of the Competition and those related to the application process, no later than 28 March 2024. Replies will be published on the on the competition website www.onplanlab.com/souteze/umelecka-soutez_pomnik-general-a-kutlvasra-v-nuselskem-pivovaru/ within 5 working days of receipt of the question.

Questions on the Competition Brief can be raised by the entrants no later than 8 March 2024. Replies will be published on the on the competition website www.onplanlab.com/souteze/umelecka-soutez_pomnik-general-a-kutlvasra-v-nuselskem-pivovaru/ no later than 15 March 2024.

3.1.3 Site Visit

The site is currently under construction and is not freely accessible. guided site visit will take place on 22 February 2024. Those interested in the site visit must register on the on the competition website www.onplanlab.com/souteze/umelecka-soutez_pomnik-general-a-kutlvasra-v-nuselskem-pivovaru/, where detailed information about the visit will also be published. Without registration or on other dates, the site visit will not be possible due to the ongoing construction.

Attendance at the site visit is not compulsory and is not condition of participation in the competition.

3.1.4 Date and Method of Competition Proposal Submission in Competition Phase 1

Proposals in Competition Phase 1 must be submitted no later than 18 April 2024 at 17:00 CEST.

Non-compliance with this deadline is reason for excluding the proposal from examination and exclusion of the participant from the competition.

The electronic parts of the proposal shall be submitted via IS Karel on the on the competition website www.onplanlab.com/souteze/umelecka-soutez_pomnik-general-a-kutlvasra-v-nuselskem-pivovaru/.

The optional parts of the proposal to be submitted physically must be submitted at the office of the competition organiser ONplan lab, s.r.o., Karmelitská 18/379, 118 00 Prague 1, on weekdays from 10:00 to 17:00.

Method of submission of the mandatory parts of the concept

The mandatory parts of the proposal concept according to paragraph 3.1.5 shall be submitted electronically in the Competition Phase 1.

Method of submission of the optional parts of the concept

The optional parts of the proposal concept according to paragraph 3.1.5 can be submitted electronically or physically, depending on which form of presentation the authors choose.

The electronically submitted part of the proposal should be submitted in commonly used formats (e.g. *jpg, *png, *pdf, *mp3, *mp4, ...), up to 200 MB in size and in the case of visual and audiovisual documents up to 5 minutes in length.

The physical submission itself must meet the requirements for anonymity of the proposal. However, the cover of the physically submitted part of the proposal should be marked with the name

of the author(s). The physical submission should be listed in the list of proposal components in the A3 publication.

No dimension of the physically submitted packaged part of the proposal should exceed 1 m and the weight of the proposal should not exceed 5 kg. At the same time, the physically submitted parts of the proposal should not require special installation, handling by the jury, etc. Physical submissions should be made of materials and in way that allows for repeated manipulation.

The competition client does not guarantee that the physically submitted parts of the competition proposal will not be damaged.

3.1.5 Requirements for the Content of the Competition Proposal in Competition Phase 1

Mandatory Requirements for the Content of the Competition Proposal in Competition Phase 1

Non-compliance with the following mandatory requirements for the competition proposal in Competition Phase 1 will be reason for excluding the proposal from examination and exclusion of the participant from the competition.

a) Anonymity of the Concept of the Memorial Proposal

The concept of the memorial proposal (both the mandatory required part and any optional part of the proposal) must be submitted anonymously – it must not contain the name and signature of the participant or password or other graphic mark that could lead to the identification of the participant and thus breach the anonymity of the proposal.

The presence of the sender's name and address on the packaging of the physically submitted part of the proposal will not be considered breach of anonymity. The Competition Secretary will ensure that the physically submitted optional parts of the proposals will be submitted to the jury without packaging.

The portfolio of reference works and the sworn statement – the completed and signed form P05 (according to section 1.6.2) will not be submitted to the jury, so the anonymity of the competition proposal will not be breached.

b) Mandatory Content of the Competition Proposal in Competition Phase 1

Competition Phase 1 proposals must include:

- the concept of the memorial proposal presented in an A3 publication, in pdf format;

- documents proving compliance with the conditions for participation in the competition (see paragraph 1.6.2):
 - portfolio of reference works,
 - Sworn Statement – completed and signed form P05.

Recommended Content of the Memorial Proposal Concept

The concept of the memorial proposal presented in an A3 publication should be no more than 6 pages long (excluding the title page and final page). The title page of the publication should contain the title of the competition „Memorial of General Kutlvař in Nusle Brewery“. The publication will be in pdf format.

The publication presenting the concept of the memorial proposal should have the following content:

The text part of the concept should contain at least the following:

- **abstract** – brief description of the conceptual intention in approximately 500 characters including spaces,
- **description of the proposed solution** – an explanation of the concept, including materials, technologies and construction design,
- **list of the proposal components**, if the competition participant decides to submit other than the mandatory parts of the concept (i.e. an A3 publication).

The graphical part of the concept should contain at least the following:

- **the site plan** – specification of the location of the work within the site, indicating the scale and basic dimensions of the work,
- **at least one view** clarifying the height layout of the work in the context of the site, indicating the scale and basic dimensions of the work,
- **at least three spatial representations of the work** – e. g. visualisation, perspective, sketch, drawing, photograph of the model, etc.

Optional Parts of the Proposal

Competition participants may supplement the required publication presenting the concept of the artwork proposal with additional optional parts. The form and quantity of these is left to the participants' choice. This may include, for example, physical model, large format print, or other visual or audiovisual representations of the proposal that help the competition participant to communicate the principles of his/her proposal.

3.1.6 Proposals Evaluation Criteria in Competition Phase 1

The equally weighted evaluation criteria by which the competition jury will judge the proposal concepts are as follows:

- a. quality of the artwork,
- b. the extent to which the brief has been met,
- c. the sustainability of the proposal.

The jury will evaluate the concepts of the memorial based on the knowledge and experience of its members, who may take into account the expertise of invited experts. The evaluation will therefore be professional but subjective opinion of the jury. By participating in the competition, participants agree to this method of evaluation.

3.1.7 Selection of the Proposals that will Proceed to the Competition Phase 2

The date of the jury meeting to evaluate the competition proposals in Competition Phase 1 is tentatively set for 22–25 April 2024. The exact date of the evaluation meeting will be set during the competition.

Based on the jury's recommendation, the competition client will invite the authors of up to 7 memorial concepts to submit proposals for the Competition Phase 2. The invitation will include jury recommendation for further development of the concept, specification of the requirements for submission of the proposal and an invitation to the competition workshop.

Participants who do not proceed to Competition Phase 2 will receive notification and will no longer participate in the competition.

3.1.8 Competition Phase 1 Rewards

Competition Phase 1 participants are not entitled to any reward or other financial compensation for submitting competition proposal.

3.2 Competition Phase 2

Competition Phase 2 participants are only those authors who have been selected for Competition Phase 2 and have been invited to complete and submit their proposals. Participants will present their finalized memorial proposals to the jury at competition workshop. After the workshop, the jury will select the winner of the competition.

3.2.1 Competition Phase 2 Questions

In Competition Phase 2, competition participants can only submit questions in writing to the email address dotazy@kutlvasr.onplanlab.com. Deadlines for submitting questions will be specified in the invitation to participate in Competition Phase 2.

3.2.2 Date of Competition Proposal Submission in Competition Phase 2

The deadline for submission in Competition Phase 2 will be minimum of 50 days from receipt of the invitation to participate in Phase 2, tentatively 20 June 2024 by 17:00 CEST.

3.2.3 Requirements for the Proposal in Competition Phase 2

The requirements of the competition proposal and the method of submission will be specified in the invitation to participate in Competition Phase 2. It is expected to prepare 2 competition panels in A1 format, text part and model.

3.2.4 Competition Workshop

The aim of the competition workshop is to present the individual proposals, to introduce the participants and the authors of the proposals and to discuss the proposals among the authors of the proposals, the jury and the invited experts.

The workshop programme will be specified in the invitation to participate in Competition Phase 2. Each participant is expected to have 15 minutes for the presentation of their proposal, followed by 10-minute discussion.

The competition workshop will be followed by closed jury meeting during which the jury will evaluate the proposals based on the proposal evaluation criteria in Competition Phase 2 and define the order of the proposals recommended for implementation.

The date of the competition workshop is tentatively set for 24–27 June 2024. The date, time and venue will be specified in the invitation to participate in Competition Phase 2.

3.2.5 Proposals Evaluation Criteria in Competition Phase 2

The criteria by which the competition proposals will be evaluated in Phase 2 are tentatively set, without order of importance, as follows:

- a. quality of the artwork,
- b. the extent to which the brief has been met,
- c. level of functional-operational and technical solution,
- d. the sustainability of the proposal, taking into account investment and operational costs.

The jury will evaluate the proposals of the memorial based on the knowledge and experience of its members, who may take into account the expertise of invited experts. The evaluation will therefore be professional but subjective opinion of the jury. By participating in the competition, participants agree to this method of evaluation.

3.2.6 Competition Phase 2 Rewards

All Phase 2 participants who submit proposal for the memorial to General Karel Kutlvašr by the deadline, subsequently present it at the competition workshop and meet the Rules of the Competition will receive reward of CZK 85,000.

3.3 General Terms

3.3.1 Public Exhibition of Competition Proposals

The public exhibition of the competition proposals will start no later than 90 days after the proposal submission deadline of Competition Phase 2.

3.3.2 Copyright

The Competition Client declares that the competition proposals are considered to be works protected by copyright as defined in the latest amendment of Act No. 121/2000 Coll., on Copyright and Related Rights and on Amendments to Certain Acts (Copyright Act), as amended.

The submission of the designs and deliverables is not deemed transfer of copyright to the Competition Client or to any third person in the competition, and the copyright stays with the authors of the deliverables.

However, without the prior written consent of the Competition Client, the authors are not allowed to publish their designs and deliverables or use them for any purpose other than participation in this competition. The Competition Client will not unreasonably decline consent to publish the designs.

By entering the competition, the participant agrees to grant an Exclusive License (hereinafter referred to as "Licence") to the Competition Client in terms of the subject matter, time and place including the following rights:

- a. to fully or partially copy or reproduce the competition proposals of the participants with the aim of promoting the competition and presenting its outcomes,
- b. to decide on the form and conditions of publishing or publicly reproducing or distributing the participant's proposals submitted in the competition,
- c. to publish or publicly reproduce or distribute the participant's proposals or their parts, including public exhibition of the competition proposals,
- d. to use the participant's proposals submitted in the competition for consultation with the public administration bodies, local councils and third parties in relation to the planned projects in the competition area.

The Competition Client is entitled to transfer the Licence or grant sub-licence to any party associated with them in any way, to the Organiser, the City of Prague, Municipal District Prague 4, organisations established or controlled by them and to other third parties who demonstrate legitimate interest in the development of the site. The Licence is not limited in time.

If the competition is cancelled (see 3.3.3), the rights of the Competition Client granted by the Licence are not affected.

The participants must prove that they are authorised (hereinafter referred to as "Authorisation") to grant the Licence to the Competition Clients. Proof of Authorisation is required for the deliverables in each phase in the following way:

- a. via signed Sworn Statement confirming that the participant is the author of the submitted deliverables,
- or
- b. via signed licence agreement between the author/and the participant that will, among others, include the granting of the Licence to the participant to use the deliverables for participation in the Competition and provision of the Licence.

The use of the design proposals or any of their parts for any purpose other than those stated in these Rules of the Competition requires the explicit consent of the authors.

3.3.3 Cancellation of the Competition

The Competition Clients reserves the right to cancel the Competition without providing any reason.

If the competition is cancelled before the competition workshop in the Competition Phase 2, the Competition Client is obliged to compensate those competition participants who were invited to participate in Competition Phase 2 and who can prove that before the competition was cancelled, they had completed most or part of the deliverables required in Competition Phase 2. The reimbursement will correspond to the amount of work completed, but will not exceed CZK 60,000.

The Competition Client will ask the jury to review the scope of completed work of every participant and set pro rata reimbursement corresponding to the amount of work completed.

3.3.4 Language of the Competition

The competition is announced and will be carried out in Czech. All parts of the deliverables in Competition Phase 1 must be produced in Czech.

The Rules of the Competition and the Competition Brief will be published in English as well. In case of any uncertainty as to the correctness of the translation, the Czech version of the Rules of the Competition is always binding.

3.3.5 Rewards and Taxation

The participants have the duty to tax the reward and prize money awarded to them in Competition Phase 2 according to the applicable laws in the country where they are tax residents.

3.3.6 Raising Objections

Pursuant to the Competition Guidelines of the Czech Chamber of Architects, every participant in the competition can raise justified objections to the Competition Client against the acts of the Competition Client linked to the competition and against the jury's formal procedures. Objections can be raised within 15 days after the delivery of the competition results to the participant.

The objection must state which procedure of the jury or act of the Competition Client constitutes the reason for raising the objection, what is considered to be the breach of the Rules of the Competition, and what redress the complainant is seeking.

The Competition Client together with the jury will review the full scope of the objections raised and, within 10 days of their receipt, will send written decision to the complainant stating whether they accept the objection or not.

4 Additional Information



Figure 1 Brigadier General Karel Kutlvašr, source: from family archive provided by Pavel Švec

4.1 Kdo byl generál Karel Kutlvař?

Life Motto: DIEU – PATRIE – NOBLESSE

**Story of Courage, Heroism, Love;
Story of Honour, Chivalry, and Pain**

It is July 2, 1917, the plains near Zborov are crossed by winding lines of trenches. On one side lie well-fortified Austro-Hungarian and German troops, on the eastern side there are Russian troops, which include the underrated and poorly armed Czechoslovak Rifle Brigade of 3,500 determined men.

After the artillery preparation, at 9:07 a.m. the grenadiers of the Czechoslovak assault troops run out from the forward post called Marusja. battle that will go down in history starts.

Later the commander of the 4th Company of the 1st Regiment, Karel Kutlvař, described the dramatic moments of the battle as follows:

"The fight rages on, every second is an eternity to me. run alone to the centre and command: Forward! We rush like mad through the valley and over the wire obstacles into the enemy trenches. half of my troop moves through the trenches, go with them, but soon it seems to me too slow, so jump up on the top of trenches and move faster forward between the first and second lines of defence. Heavy shells are falling all around. The fallen lie in and on the trenches. One of our fallen, as spotted him at speed, seemed familiar to me. He was lying face down immediately in front of the obstacles of the second Austrian defence line at the embankment of the connecting corridor. His rifle nearby. He was holding his forehead with his left hand. That was my brother František. realized after the battle how worried František was before the attack, recalled his sad eyes as he looked at me as he was passing me on the morning of July 2. felt his hand squeezing mine."

Karel Karel Kutlvař and Zborov. This is story of heroism. The trenches of Zborov turned peasant son into legendary commander. The memorable battle contributed to the fact that the world began to take the idea of Czechoslovakia as an independent state seriously.

The Kutlvař family comes from Michalovice, village near Havlíčkův Brod. The family farm still stands there. Karel has memorial plaque next to the gate, František's name is engraved on the WWI monument

to the fallen situated in the middle of the village. Memorials made in stone reminding of two different fates.

After studying at the business academy and short career as clerk, Karel left for Kiev in April 1913 to work there. This was start of his new phase of life far from his homeland. He would not return home until almost seven years later.

In summer 1914, war breaks out in Europe. Soon Karel joins the emerging volunteer Czech Družina, the founding unit of the future Czechoslovak Legion on the Russian front. He becomes hero of the dangerous reconnaissance in Halych, the battles of Penza, Samara or Bugulma; he takes part in the battles of Simbirsk and Kazan, where he is wounded likewise at Zborov battle. As commander of the 1st Czechoslovak Rifle Regiment he fights on the Belebey front and together with his men protects the Siberian railway. He is awarded many highest honours.



Figure 2 Major Karel Kutlvař, end of 1918. On his chest is complete set of Russian decorations, from left: the Order of St. George 4th class, the Cross of St. George for officers, the Order of St. Anna 3rd class with swords and ribbon, the Order of St. Stanislaus 4th class with swords and ribbon and the Cross of St. George 4th class.
Source: from family archive provided by Pavel Švec

Note: Chapter 4.1 was written by Mr Petr Švec, the great-great nephew of General Karel Kutlvař.

This Is Story of Extraordinary Courage

Karel Kutlvař returned to Czechoslovakia as lieutenant colonel on 1 February 1920. The following day he was appointed commander of all the so-called „Russian troops” in his homeland. In Russian Siberia, he fell in love with Yelizaveta Yakovleva, whom he brought with him.

few weeks after he met her, he confided in his diary:

“Letters from Lisa. And what letters! am so happy. draw the elixir of life from them. She wrote two poems, which she sent to me. They prove her deep thoughts, sensibility, and sincerity! This is woman who can make me happy. Her soul, her whole being is filled with tenderness, truthfulness, and life! What have done to deserve the love, the true love, of this wonderful girl, loved and admired by all. cannot hide my feelings; they are too strong.”

It is love that never fades. The wedding is on July 28, 1920 at the Old Town Hall. Lizotchka stood by her husband even in the most difficult moments. The fatefully tragic ones came in the late 1940s, when the Communists took power in Czechoslovakia.

After returning to his homeland, Kutlvař held many important positions in the army and was based in Prague, Chomutov and Milovice. At the

age of 33, he was promoted to brigadier general, becoming one of the youngest generals in the Czechoslovak army. He is subsequently appointed commander of the 4th Division in Hradec Králové. Here he is caught up in the mobilisation and the Munich Agreement under which large portion of the country is given to Germany and finally the German occupation of the rest of the country.

General Kutlvař was discharged from the army and started working in the Prague City Administration as Senior Councillor. He had secret assignment: to prepare the defence of Prague when the German army retreats or at the end of the war. Kutlvař joins the military resistance in the ranks of the famous Defence of the Nation. He luckily escapes arrest.

It is 5 May 1945. An uprising against the German occupiers breaks out in Prague. And the general is doing what he has been preparing for intensively for the last few months. He will lead the revolution. He fearlessly commands hundreds, thousands and eventually tens of thousands of ill-equipped insurgents who are outnumbered by the Germans who have taken Europe's last occupied capital in tight grip.



Figure 3 Colonel Karel Kutlvař with his wife Yelizaveta Yakovleva and her mother Agripina, source: from family archive provided by Pavel Švec



Figure 4 General Karel Kutlvař at the „Bartoš“ headquarters during the Prague Uprising in May 1945, source: from family archive provided by Pavel Švec

Legend is Born

The four days of the Prague Uprising become the largest, most heroic and bloodiest fight of the Czechs on their own territory in modern history. The fights claim three thousand dead, murdered and killed. Karel Kutlvař negotiates with General Rudolf Toussaint the conditions for the surrender of German troops in Prague. In exchange for their free passage through the city to the captivity of the Western Allies.

The Czech general, leaving the room where the agreement was signed on Tuesday 8 May, laconically said to his chief of staff, „*There will be an aftermath*“. It is as if he anticipated that none of the signatories to this act would be appreciated by those who never were and never will be responsible for anything. Most likely he was not yet able, like everyone else, to envisage the extent of Soviet vindictiveness against those who dared to act in the Soviet sphere of influence without Moscow's blessing.

Unfortunately, as it often happens in the Czech history, it turned out that Kutlvař was right. A few months after the communist coup, in mid-December 1948, he was arrested. Even behind bars he lost none of his typical gentle manners and dignity. During interrogations, he never allows himself to be provoked into saying anything rude to others or denunciatory. Half year later, he is degraded in show trial and sentenced to life imprisonment.

This Is Story of Disappointment and Pain

The time of unjust imprisonment: 11 years, 4 months and 22 days. In May 1960, private Kutlvašr was released under the amnesty declared by the Czechoslovak President. „*The third phase of our lives starts, be merciful to us, Our Lord!*” writes Yelizaveta in the family guest book of Kutlvašr’s nephew, Václav Švec.

Her pray was not heard.

Although General Kutlvašr was already sixty-five years old when he returned from prison, he was denied retirement pension. He had to earn extra money as guard at the Prague Castle Riding Hall. But soon he was fired because visitors recognised him and engaged in conversation with him. He accepted job as night janitor at the Nusle Brewery. However, his health started deteriorating. His long stay in communist prisons took its toll. The legendary commander Karel Kutlvašr died suddenly on October 2, 1961, during routine medical check in Motol hospital.

He received recognition only after the fall of communism, when President Václav Havel promoted him in memoriam to the rank of army general and awarded him the Order of Milan Rastislav Štefánik. quarter of century later, he was awarded the Order of the White Lion.

„It was wonderful circle of life. Unfortunately, there is gap in it. know I’m probably going to die soon, but can never stop thinking about it. Those endless and unjust twelve years, from 1948 to 1960. gap still don’t understand. For what? Why?” said Yelizaveta Kutlvašrová after her husband’s death. She died on 5 July 1980 in Prague.



Figure 5 In late 60s the case of Karel Kutlvašr, who had already died in 1961, was reopened. View of the courtroom, where the widow Yelizaveta Kutlvašrová and the general’s nephew, former factory owner Václav Švec, were present. For many years they both had been trying to clear Karel Kutlvašr’s name. However, he was not fully acquitted until after the fall of communism. Source: from family archive, provided by Pavel Švec

4.2 Nusle Brewery Regeneration Project

4.2.1 History of the Nusle Brewery

18th Century

In the first half of the 18th century, Jan Josef, the Count of Vrtba acquired the land and mill which he substantially rebuilt. The mill was located on the site of today's brewery. The first record of beer brewing at the Nusle estate comes from 1757 – at that time it was already an established business, producing 652 barrels of beer annually.



Figure 6 Nusle in the obligatory imperial imprints of the Stable Cadastre from 1826–1843. North of the Botič stream there is the mill building and the mill race, source: ags.cuzk.cz

The Second Half of the 18th Century

In the second half of the 19th century, new residential houses for rent were built, and industry developed in Nusle. The Nusle Brewery was also expanded and modernised several times. In 1897, the final transformation from craft to machine beer production took place. The brewery and maltings called "Steam engine brewery and malt house in Nusle near Prague" ("Akciový parostrojní pivovar sladovna Nuslích Prahy") became the fourth largest brewery in Bohemia.

At the turn of the 19th and 20th centuries, the brewery's large garden with restaurant was the centre of Nusle's social life. Concerts, dance parties and social events were held here, and films were shown in the cinema. The brewery restaurant was also used by various associations for meetings, lectures, and other events.

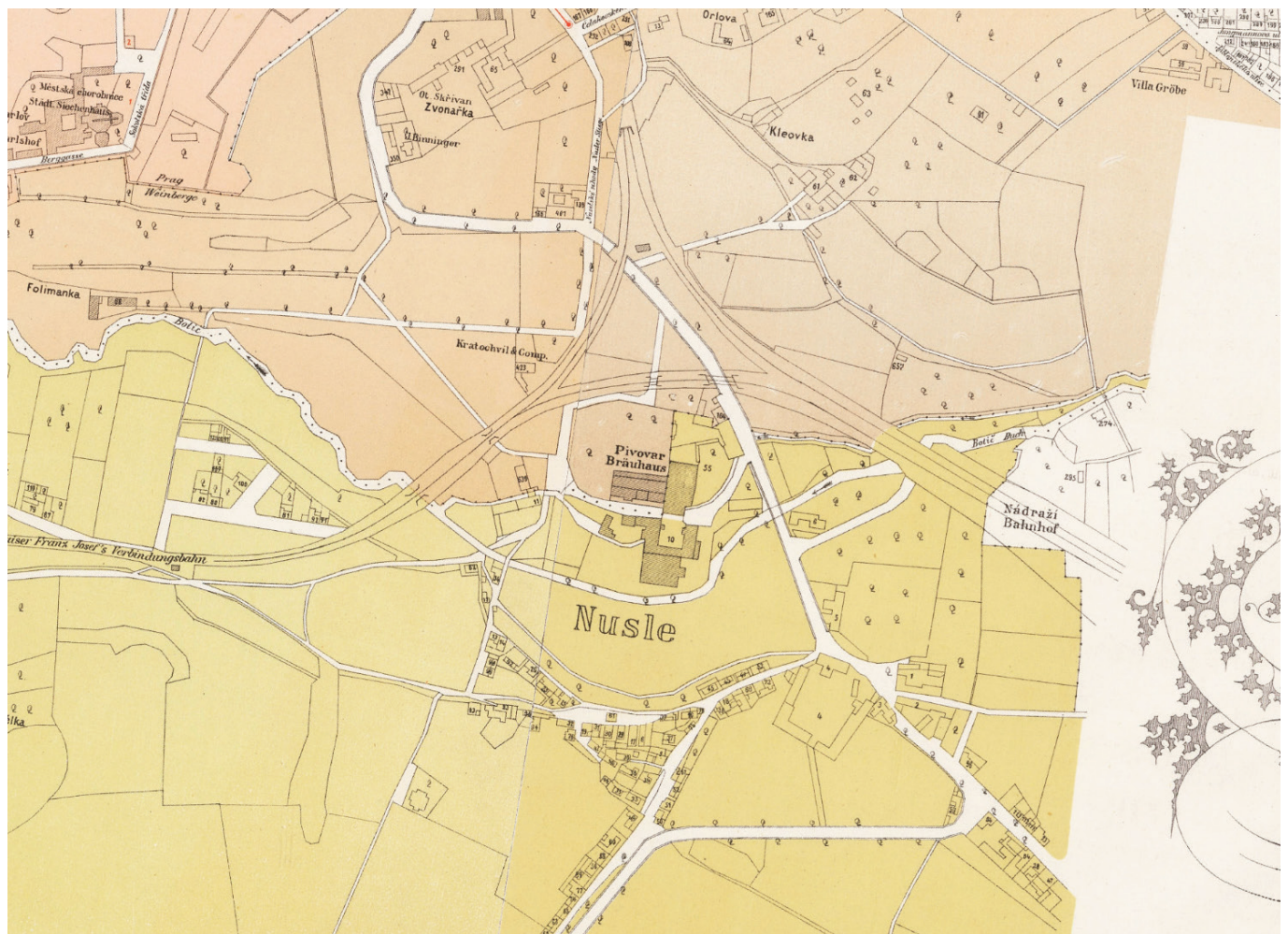

Figure 7 The Nusle Brewery shown in the Topographic Map of the Royal Capital of Prague from 1880, source: geoportalpraha.cz



Figure 8 The Nusle Brewery in the Elevation Plan of the City of Prague in 1920–1924, source: geoportalpraha.cz

20th Century

During World War II the brewery was occupied by the German army and beer production stopped. After the war, the brewery buildings were dilapidated, however beer production was resumed. In 1948, the "Praha-Nusle" brewery was nationalised and incorporated into the national enterprise called "Prague Breweries". Beer was brewed here only until 1960. The malt house which supplied the Smíchov brewery stayed in operation until 1976.

"Czech wine factories" ("České vinařské závody") moved into the brewery processing grapes from Moravia, Slovakia, Hungary, Austria, Yugoslavia and other countries. The most famous and popular wine produced there was called "Original Cellar Master" ("Původní sklep mistr"). The production of wines ended in 1997.



Figure 9 Nusle Brewery with the adjacent factory in 1910, source: www.jamrtal.com



Figure 10 View of the brewery in the early 20th century, source: www.jamrtal.com

Early 21st Century

In 2000 some brewery buildings were listed as cultural heritage. The listed buildings are situated in the south, i.e. the set of buildings with the Baroque core of the brewery, the Classicist building of the restaurant, the malt house, the malt drying kiln, the brewhouse, the cellar, the boiler house chimney, and the Art Nouveau brewery gate.

In 2016 the site including the buildings was acquired by Penta Real Estate, the company which is now carrying out its regeneration.

Note: The text is based on the historic building survey of the listed buildings of the former Nusle Brewery in as published in "Věstník Muzea cenných papírů" (Volume X, Issue 12) and website www.jamrtal.com.



Figure 11 In 1918, the Art Nouveau gate in Bělehradská Street became an impressive addition to the premises, with the brewery's bronze initials „NP” in its grille. They were replaced in 2012 by the inscription „České vinařské závody”. Source: nuselskypivovar.cz, 2023

4.2.2 Nusle Brewery Regeneration Project

The aim of the brewery regeneration project is to use private funds to save this cultural heritage and transform the brownfield into safe neighbourhood with superior public spaces.

The Nusle Brewery regeneration project will offer diverse functional mix. Retail outlets, restaurants, services and office space will be concentrated mainly in the brewery historic buildings and their new extensions in the south of the site. The brewery listed buildings are being restored to preserve and, if possible, to emphasise all their valuable features and open them to the public. These spaces will be flexible to accommodate wide range of programmes and meet the requirements of future owners and the public. This part of the project is being developed under the leadership of CMC Architects.



Figure 12 Bird's eye view of the regenerated brewery site towards the northwest, source: Penta Real Estate, 2023



Figure 13 The view of the historical building of the brewery with the café outdoor seating and the ramp leading towards the shopping mall, source: Penta Real Estate, 2023

In the north, new residential development inspired by the typical blocks of buildings in Nusle is being built under the leadership of the Chybík + Kristof studio. The façades and materials used in this development are inspired by features of the historic brewery buildings. The development includes wide range of apartments with different layouts and with balconies, loggias, terraces, or front gardens. There will be inner courtyards with plenty of vegetation which will form quiet zones for leisure and relaxation for the residents of the new neighbourhood. Three residential tower blocks of 9 storeys accentuate the otherwise uniform development structure. These tower blocks refer to the industrial past of Nusle and, together with the brewery chimney and other chimneys in the Nusle Valley, will complement the character of this Prague neighbourhood.



Figure 14 Bird's eye view of the residential part of the Nusle Brewery site from the east. The view shows the central public space connecting the old buildings with the modern development, source: Penta Real Estate, 2023

The main public space of the new neighbourhood is the "Brewery Square" ("Pivovarské náměstí") situated between the brewery historic buildings and the new residential area. The square is connected by passage in the historic brewery building and footbridge over the Botič with Křesomyslova Street. The square will host markets and minor cultural and social events. The General Karel Kutlvašr memorial will be located on the square.



Figure 15 Visualization of the view of the central part of the public space of the regenerated site. In the south, to the left, there is the historic brewery, in the northern part there is the new residential development, source: Penta Real Estate, 2023

Car traffic will be excluded from almost the entire site of Nusle Brewery. The public spaces will be in the form of pedestrian areas with limited delivery traffic across the new "Brewery Square" ("Pivovarské náměstí") to the commercial premises in the historic brewery buildings. Parking will be in the underground garages under the residential buildings and the brewery extensions. The underground parking capacity is sufficient to avoid new residents parking their vehicles on the streets around the site. Access to the underground car parks is planned from Závěšova Street.

For more information on the project, please go to the following websites: www.nuselsky-pivovar.com and www.pentarealestate.com/cs/nase-projekty/nuselsky-pivovar-19/.

Project Timetable

2018 Public participation in the site regeneration. Public participated in shaping the design of the public spaces and outlining programmes for non-residential spaces.

Brewery Restoration

January 2023	Start of the restoration
August 2024	Building works finished
1st quarter 2025	Restoration completed

New Residential Development

1st quarter 2021	Construction starts
September 2023	Building work finished
2nd quarter 2024	Buildings completed
1st quarter 2025	Completion of the project



Figure 16 Guided tours of the brewery as part of the public participation in the project preparation in 2018, source: ONplan, 2018



Figure 17 Public discussion of the design of the Nusle Brewery, which took place as part of the public participation in the preparation of the project in 2018, source: ONplan, 2018



Figure 18 Restoration of the brewery historic building under way in 2023, the picture shows the future square, source: nuselskypivovar.cz



Figure 19 Brewery historic building restoration and construction of the new residential buildings in 2023, source: nuselskypivovar.cz

Art Competition
Memorial to General Kutlvař in Nusle Brewery
Rules of the Competition and Competition Brief

© ONplan lab, s.r.o., 2024

Illustrations: Dana Ledl
Graphic design: Fausto Prezioso, Dorotea Dlesková
English translation: Marta Nedvědická, Dorotea Dlesková

Issue 02/2024

PENTA
REAL ESTATE

ON | Art of
plan | planning.
Together.

